

FANMATE®

FEATURING **EZClip™** by **MAXXAIR®** VENTILATION SOLUTIONS
SUPERIOR RAIN PROTECTION • OPTIONAL BUG SCREEN



ASSEMBLY AND INSTALLATION INSTRUCTIONS
FOR MODELS: SMOKE 755, WHITE 855, AND BLACK 955



READ AND SAVE THESE INSTRUCTIONS

WARNING: Improper installation, adjustment, alteration, service or maintenance will void warranty and can cause property damage, personal injury or loss of life. Installation of this unit must be made in accordance with the written instructions provided in this manual. No agent, representative or employee of AIRXCEL, INC. or other person has the authority to change, modify or waive any provision of the instructions contained in this manual.

CONTENTS

QTY	DESCRIPTION	QTY	DESCRIPTION
1	Vent Cover Body	4	#8-32 x 1/2" SS Phillips Head Screws
1	Louver Section	4	#8 SS Nuts
4	Aluminum Brackets	4	#8 SS Fender Washers
4	EZClip™ Pins	4	#8 SS Lock Washers
8	#6 x 1/2" SS Self-tapping Screws (for installation over high-powered fans)		

TOOLS REQUIRED

DESCRIPTION
POWER DRILL with 3/16" & 3/32" drill bits
Adjustable Wrench (or 11/32" end wrench)
Phillips Head Screwdriver (#2)
Pencil

OPTIONAL BUG SCREENS AVAILABLE FOR LOUVER SECTION

FOR SMOKE 755 **FANMATE®**, ORDER SCREEN P/N: 00-955203

FOR WHITE 855/BLACK 955 **FANMATE®**, ORDER SCREEN P/N: 00-955202

SEE RV DEALER, PARTS SUPPLIER OR RETAILER FOR DETAILS

ASSEMBLY OF FANMATE® VENT COVER

1. Place **FANMATE®** Vent Cover Body on a flat surface.
2. Lay Louver section behind opening of vent cover body with tabs up as shown in Figure 1.
3. Slide oval shaped tabs on Louver section through the slots on the Vent Cover Body.
4. Rotate Louver section upward and snap into top of the Vent Cover Body. Make sure the Louver edge goes behind the tabs inside of the Vent Cover Body as shown in Detail A in Figure 2.
5. Be sure all three (3) snaps are secured and both oval shaped tabs remain in the slots as shown in Details B and C in Figure 2.
6. This concludes the Assembly of the **FANMATE®** Vent Cover. Please proceed to the **INSTALLATION INSTRUCTIONS**.

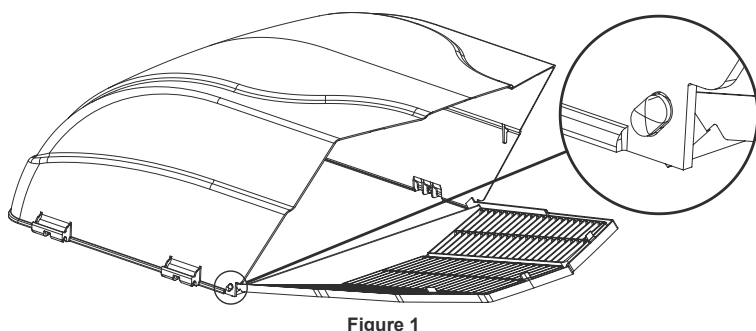

Figure 1

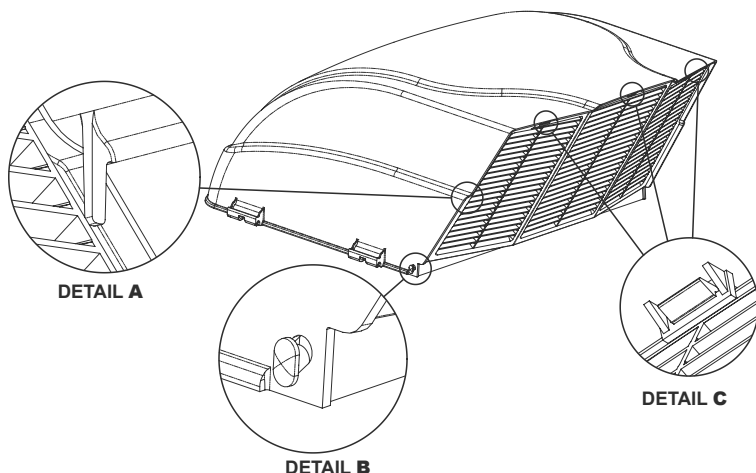

Figure 2

INSTALLATION INSTRUCTIONS FOR MAXXFAN® and MAXXFAN® Plus FANS WITH BUILT-IN Mounting tabs

1. Place **FANMATE®** over the four (4) mounting tabs on the **MAXXFAN®** with the louvers facing the rear of the vehicle. See Figure 3.
2. Slide the **EZClip™** pins into place as shown in Figure 4. Rotate the **EZClip™** pins upward to lock into position on top of the mounting tabs.

INSTALLATION INSTRUCTIONS FOR MAXXFAN® STANDARD FANS WITHOUT BUILT-IN Mounting tabs

1. Remove the plastic plugs from the side walls of the **MAXXFAN®** and fasten the mounting brackets into the pre-drilled holes using the #6 x 1/2" screws provided.
2. Slide the **EZClip™** pins into place as shown in Figure 4. Rotate the **EZClip™** pins upward to lock into position on top of the mounting tabs.

PLEASE REFER TO THE REVERSE SIDE OF THIS INSTRUCTION SHEET FOR ADDITIONAL INSTALLATION OPTIONS.

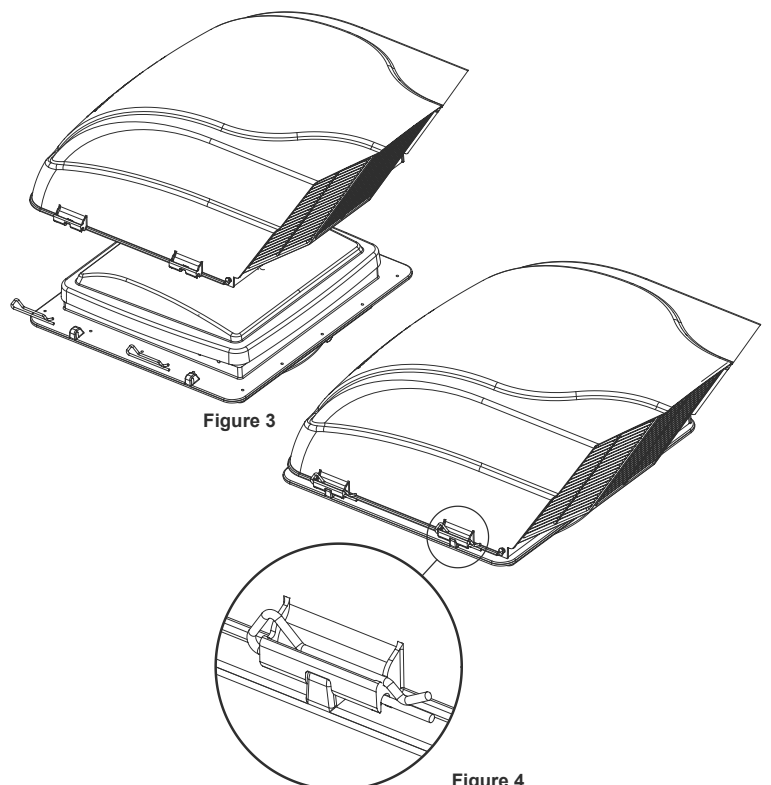

Figure 3

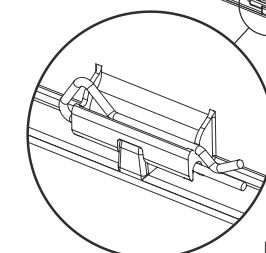

Figure 4

INSTALLATION INSTRUCTIONS

FOR STANDARD ROOF VENTS AND MOST HIGH-POWERED FANS

1. Install two (2) brackets to one side of the **FANMATE®** using two (2) of the **EZClip™** pins provided. See Figure 5.
2. With the louvers facing the rear of the vehicle, slide the **FANMATE®** up against the side of your roof vent or fan as shown in Figure 6. Center the brackets front to back on vent side wall.

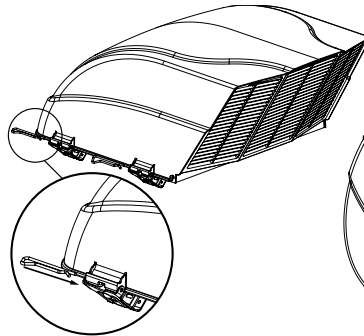

Figure 5

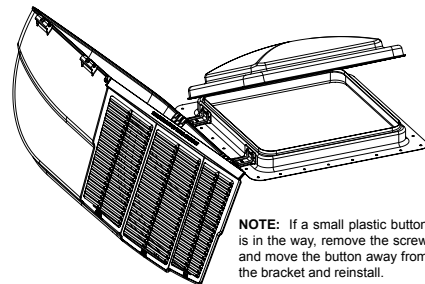

Figure 6

NOTE: If a small plastic button is in the way, remove the screw and move the button away from the bracket and reinstall.

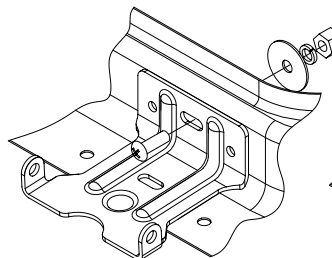

Figure 7

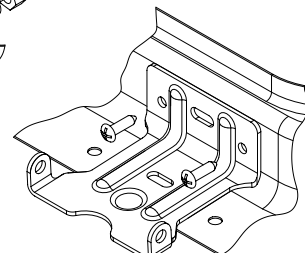

Figure 8

3. Close the **FANMATE®** and mark the location of the feet onto the roof on the opposite side. See Figure 9.
4. Line up the remaining two (2) brackets with the marks just made in step 3 on the roof as shown in Figure 9.

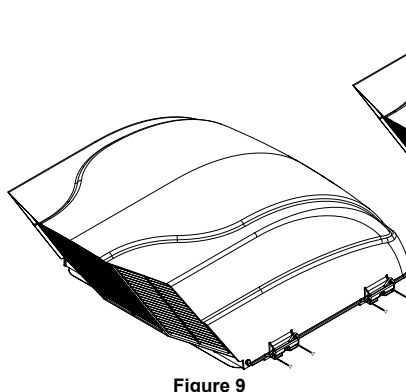

Figure 9

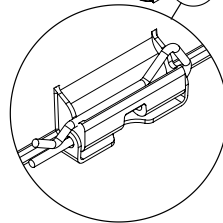

Figure 10

- A. FOR STANDARD ROOF VENTS:**
 - i. Mark the center of the slot of the brackets onto the side wall of the vent.
 - ii. Drill a 3/16" hole at each mark through the side wall of the vent.
 - iii. Fasten the brackets to the roof vent using the #8-32 screws with the fender washer, lock washers and nuts on the inside of the roof vent side wall. See Figure 7.

- B. FOR FANTASTIC VENT OR SHURFLO FANS:**
 - i. Mark the two (2) outer holes of each bracket onto the side wall of your fan.
 - ii. Drill a 3/32" pilot hole at the center of each mark. DO NOT drill more than 1/2" deep to avoid damaging internal wiring.
 - iii. Fasten the brackets to the fan side wall using two (2) #6x1/2" long screws provided for each bracket. See Figure 8.

5. Close the **FANMATE®** and slide the other two (2) clips into place as shown in Figure 10. Rotate the **EZClip™** pins upward to lock into position on top of the mounting tabs.

This concludes the INSTALLATION.
ENJOY YOUR NEW **FANMATE®** Vent Cover.

THE MAXXAIR® SOLUTION FOR RV VENTILATION

MAXXFAN and MAXXFAN Plus with MOUNTING TABS

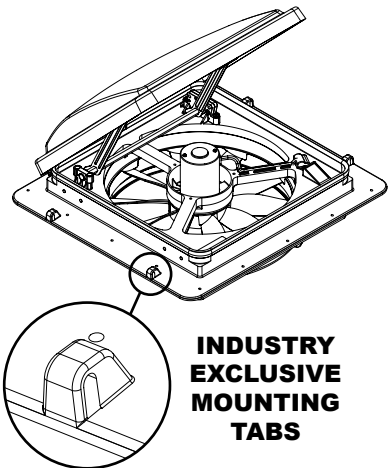

**INDUSTRY
EXCLUSIVE
MOUNTING
TABS**

MAXXFAN AND MAXXFAN Plus MODELS

- ▶ BUILT-IN waterproof molded mounting tabs
- ▶ INDUSTRY EXCLUSIVE MOUNTING TABS allow for FAST and TOOL FREE INSTALLATION of optional MAXXAIR **FANMATE®** MODELS 755, 855, or 955 cover (sold separately).
- ▶ Twin lifting arms help prevent lid flutter in high winds or when driving.

MAXXFAN Deluxe MODELS

- ▶ BUILT-IN RAIN SHIELD eliminates the need for any additional covers to protect your interior from rain!

ALL MODELS

- ▶ Remote control models include backup controls at ceiling - A MAXXFAN EXCLUSIVE!
- ▶ Operates with lid closed to circulate air (Ceiling Fan Mode)
- ▶ Flush Mounted, easy to clean keypad controls the fan speed, thermostat, air intake and exhaust
- ▶ Provides over 900 Cubic Feet of air per minute to keep you cool and comfortable
- ▶ Installs into all standard 14" x 14" RV roof openings
- ▶ 2 YEAR* Limited WARRANTY with LIFETIME Limited WARRANTY* on lid

MAXXFAN Deluxe with BUILT-IN RAIN SHIELD

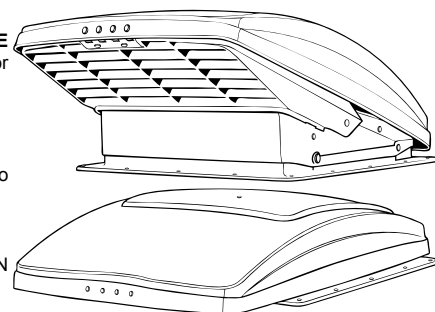

MAXXFANS are available in **MANUAL, ELECTRIC or REMOTE CONTROL** Opening Models

PLEASE VISIT AIRXCEL.COM FOR WARRANTY, MODEL INFORMATION AND SPECIFICATIONS *Warranty limited to repair or replacement

AIRXCEL, INC. - RV PRODUCTS DIVISION / MAXXAIR Ventilation Solutions warrants to be free of manufacturing defects, regardless of ownership for a period of six (6) years from the original date of purchase. You must keep your original sales receipt. This Limited Warranty does not include failure due to misuse, improper installation or accidental damages. Please call MAXXAIR® Ventilation Solutions at 1-316-832-4357 if you have any questions or need assistance.

We invite your comments and suggestions regarding our products. Any information you supply is for MAXXAIR's internal use and will not be shared or sold to others.



CAUTIONS AND CARE OF YOUR FANMATE®

This product has been manufactured using prime UV stabilized Polymers for maximum toughness and durability. However, the use of caustic or solvent based chemicals can cause cracking and product failure. **PLEASE CLEAN ALL PARTS WITH MILD SOAP AND WATER ONLY.** NOTE: Inspect the **FANMATE®** cover and **EZClips** or mounting brackets twice a year to insure a safe and secure installation is maintained.

NOTE: Most thermostatically controlled fan powered roof ventilators are designed to stop when contacting an obstruction such as a low tree branch, etc. This auto stopping feature is also used for closing the roof vent and is a normal, designed-in feature. This auto stopping feature allows the installation of our **FANMATE®** rain cover. When the vent lid automatically opens and contacts the inside of the **FANMATE®** cover it simply stops opening as it is designed to do. Then the fan, with its own separate motor, will start and run automatically.

Even though our **FANMATE®** cover prevents the fan lid from fully opening, most RVers agree - the small reduction in air flow is a worthwhile trade off to keep their RV interior safe and dry.

MAXXAIR
VENTILATION SOLUTIONS

...fresh air, rain or shine!



For additional product information please visit www.AIRXCEL.com

3050 N. St. Francis St. • Wichita, KS 67219 • 316-832-3400

© 2015, AIRXCEL, INC.

PIN: 10A11965Z
REV A, 11-2015